

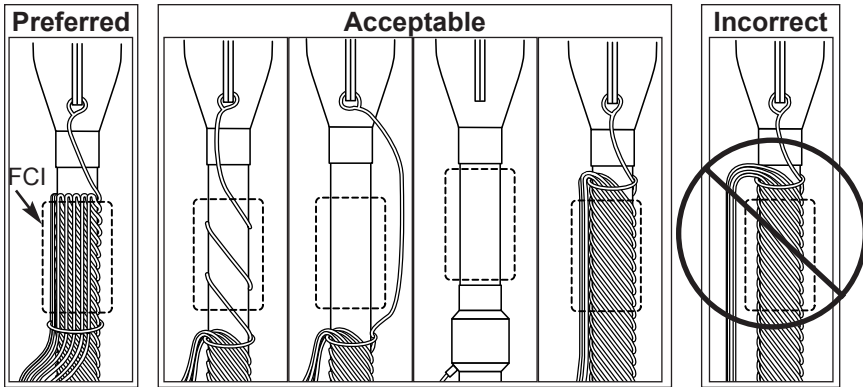

MR Installation Instructions

Before installation of fault indicators and sensors please read and understand all instructions in their entirety.
 For assistance please contact Customer Service at:
 1-847-362-8304 or by e-mail at: info@selinc.com

Caution! Install fault indicators and sensors in accordance with normal safe operating procedures. These instructions are not intended to replace or supersede existing safety or operating requirements.
Only trained qualified personnel should install or operate fault indicators and sensors.

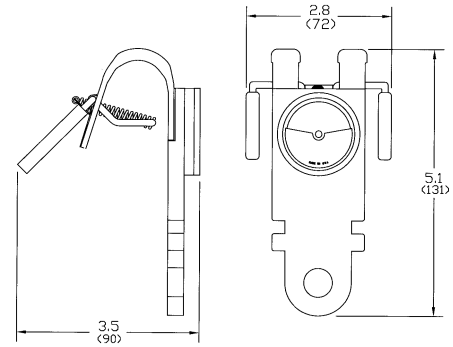

Neutral Training

The way the neutral is trained and correct placement of all FCI sensors is essential for proper function of the FCI.

Shown are several methods of neutral training. Note the position of each FCI sensor.

Double-back training is the preferred method. Four acceptable alternate methods are shown. The last method prohibits proper FCI function. Do Not Use when applying FCI sensors.

Reset the MR using MT magnet tool

Note: Before installing always use an SEL MT tool to reset an MR FCI even if the MR's target appears to be reset (white target). Use of other means to reset the MR may inhibit the MR's accuracy and functionality.

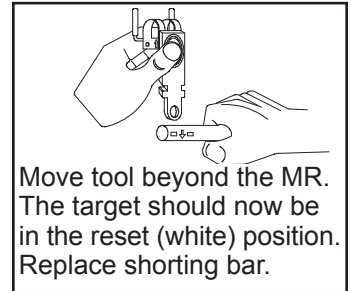
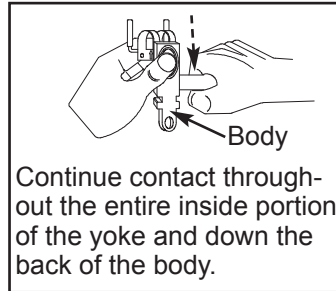
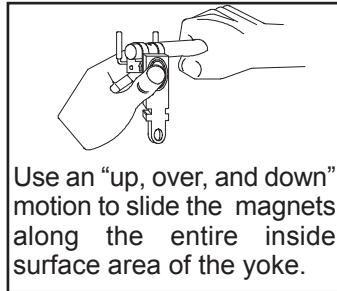
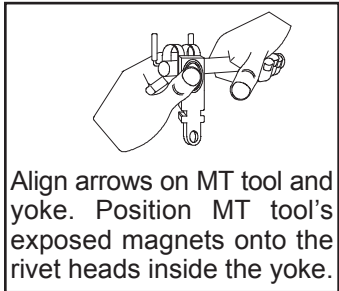
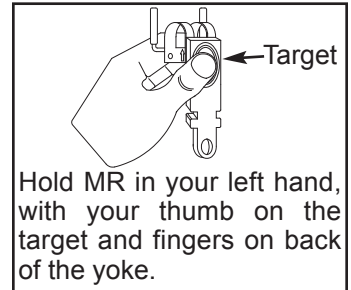
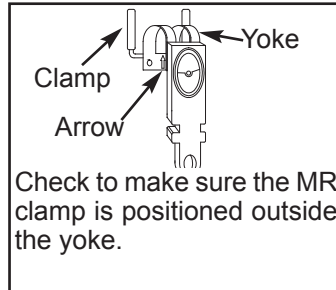
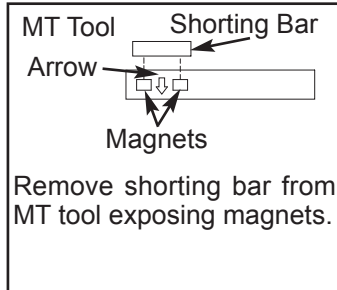

Install the MR

