



# Installation Instructions for LINAM AR

Before installation, read and understand all instructions in their entirety. For assistance, contact Customer Service at (509) 332-1890 or by email at info@selinc.com.

## ⚠ CAUTION

Install in accordance with normal safe operating practices. These instructions are not intended to replace or supersede existing safety or operating requirements. Only trained qualified personnel should install or operate fault indicators, voltage indicators, and/or sensors.

The LINAM AR Overhead AutoRANGER Fault Indicator must detect a minimum voltage field for normal operation. Therefore, install AR units at least 2 ft from other line or pole hardware when applying these units on phase-to-phase system voltages of 7.2 kV or less. In addition, be certain not to install any AR units in such a way as to reduce the insulating air gap between the product surface and any other conductor sufficiently to initiate a flashover.

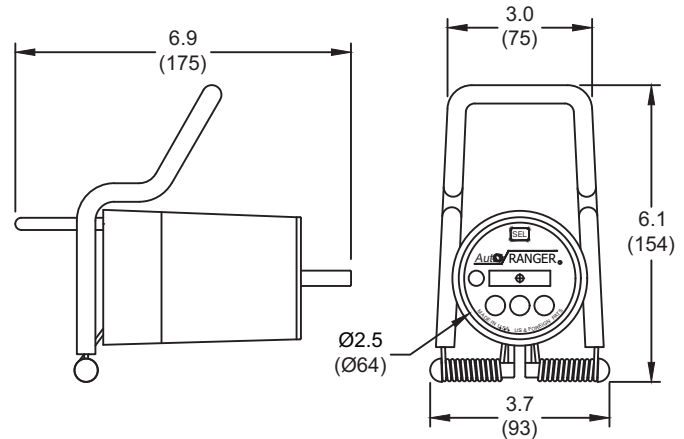

## Install the Phase Sensor(s)

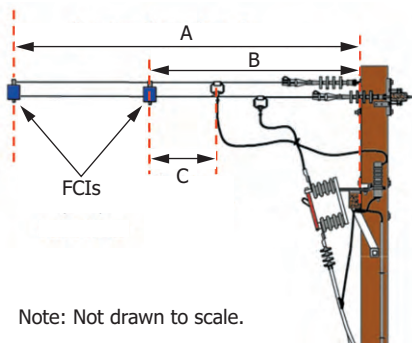
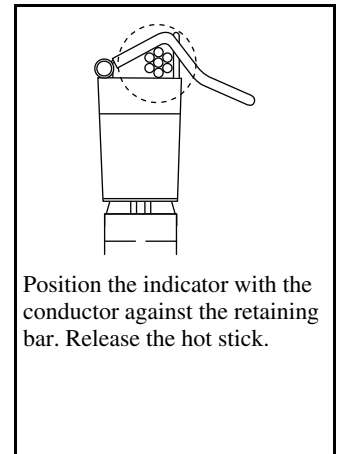
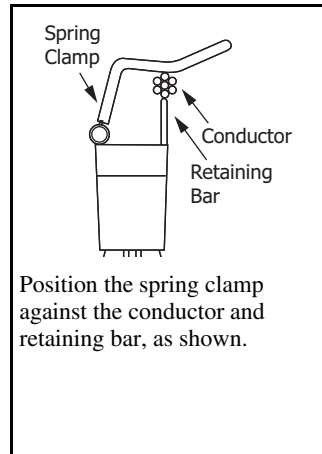
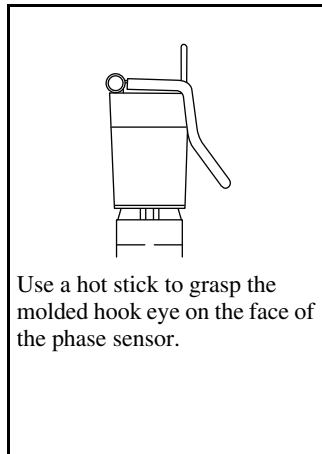
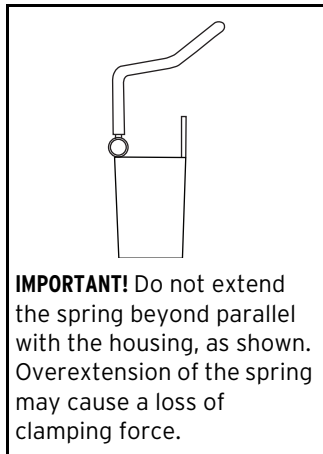

Note: Not drawn to scale.

Figure 1

To ensure optimum FCI function, SEL recommends following the FCI distance-to-pole recommendations shown in *Figure 1*.

Reference A: Maximum recommended distance from pole of 6 ft.

Reference B: Minimum distance from pole of 3 ft.

Reference C: Minimum distance from energized hardware of 2 ft.



# Installation Instructions for LINAM AR

## Test Activation and Clearing

To test activation or to clear the flash sequence of the AR, use a CRSRTT tool.

- Step 1. Remove the shorting bar from the CRSRTT tool to expose the magnet.
- Step 2. Position the exposed magnet directly beneath the SEL logo on the face of the FCI.
- Step 3. Maintain contact between the magnet and the AutoRANGER logo for 3 to 5 seconds.
- Step 4. Remove the CRSRTT from the logo and replace the shorting bar.

**Note:** The AR FCI will cycle through its flash sequence to demonstrate activation. Flash sequence is shown on the right.

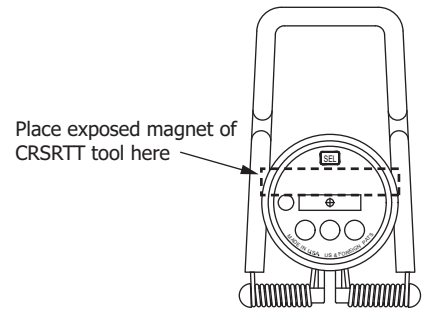

## AR FCI Flash Sequence

Red LEDs repeat several *three*-flash sequences.

Yellow LED repeats several *two*-flash sequences.

## CRSRTT Tool

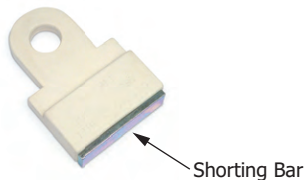

Use the CRSRTT tool to field-test many fault indicators including the AutoRANGER<sup>®</sup>, BTRIP, BTRI\_IR, and others. Before using the CRSRTT tool, remove the protective shorting bar. Replace the shorting bar after use.

Catalog Number: CRSRTT.