

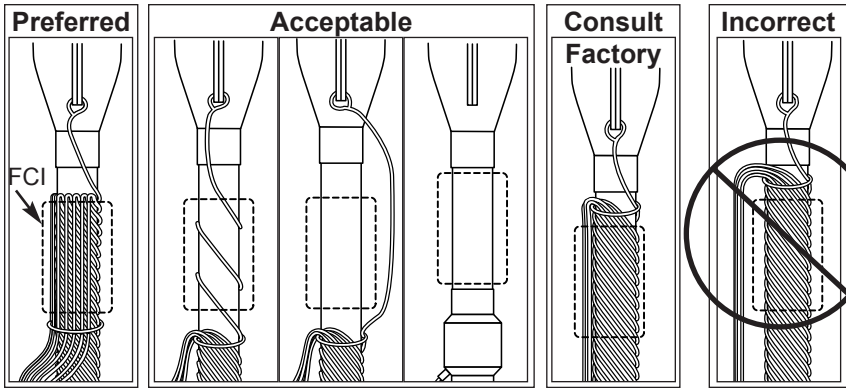

1CRI Installation Instructions

Before installation of fault indicators and sensors please read and understand all instructions in their entirety.
 For assistance please contact Customer Service at:
 1-847-362-8304 or by e-mail at: infolz@selinc.com

Caution! Install fault indicators and sensors in accordance with normal safe operating procedures. These instructions are not intended to replace or supercede existing safety or operating requirements.
Only trained qualified personnel should install or operate fault indicators and sensors.

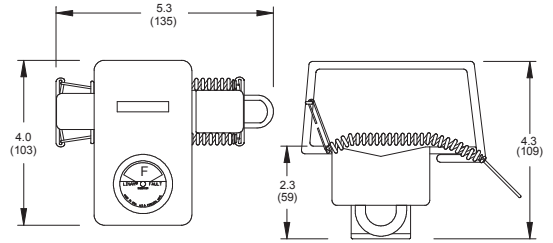

Neutral Training
 The way the neutral is trained and correct placement of all FCI sensors is essential for proper function of the FCI.
 Shown are several methods of neutral training. Note the position of each FCI sensor.
 Double-back training is the preferred method. Three acceptable alternate methods are shown. The last method prohibits proper FCI function. **Do Not Use** when applying FCI sensors.

Install the phase sensor(s)

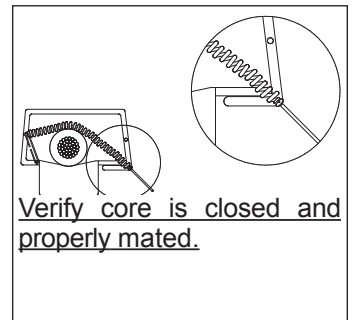
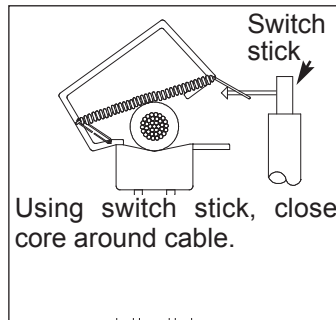
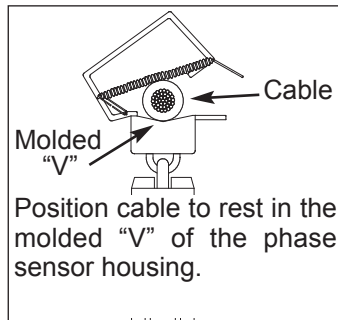
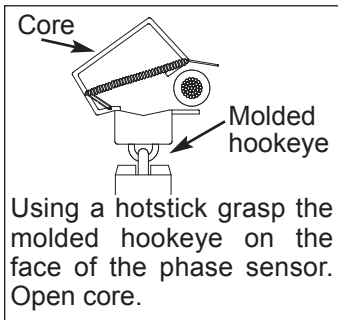

Magnetic Cable Guides hold cables and leads neatly within the enclosure.
 Order Cat. No.: **MCG**

